



# Moving into place

"THE LORD IS IN HIS HOLY TEMPLE, THE LORD'S THRONE IS IN HEAVEN" - PSALMS 11:4 (NKJV)



Place has always been important to the people of God. The place of encounter between God and man has always been remembered and recorded, finding a primary place in Scripture. God is the initiator of places of encounter. The term "The House of God" has a rich and important heritage - as Jacob declared the place of encounter, "the gate to heaven" is no other than "The House of God" (Gen 28:17). The Lord's throne is in heaven yet His presence is experienced amongst us as we gather together. This we must never forget.

Place is important to every family. We long for a home, we spend huge sums of money to secure a family home. Children flourish in the security of a home; a heritage is built, memories created and an inheritance is left. A home creates something good and leaves something good.

The house of God was important to Jesus. As a young boy, when his parents lost him for three days then found him, Jesus said, "Why were you looking for me? Did you not know that I must be in my Father's house?" (Luke 2:49). As an adult, when Jesus saw the house of God being used wrongly, he quoted the scripture and said, "My house shall be called a house of prayer for all nations" (Mark 11:17). The house of God is not the Lord, but rather a place of communal encounter with the Lord - just as making the "House of God" more important than the Lord, it is also wrong to devalue it. A place of encounter with God is a place to be highly valued as it reflects the importance we place on God's presence and communion in our shared journey.

#### 1 Chronicles 22:5

"The house to be built for the Lord *must* be exceedingly magnificent, famous and glorious throughout all countries. I will now make preparation for it."

The Lord said of David, "I have found David the son of Jesse, a man after My own heart, who will do all My will," (Acts 13:22). David was a man who had the same orientation as that of the Lord who raised the resources to build a physical place for people to gather and encounter God. David wanted the house of God to reflect the nature of God - he wanted it to be magnificent. That is our desire as well.



We have been blessed in our giving. Those who have given have seen the Lord's hand in job promotions, children added to their family, friends coming to faith in Christ, relationships reconciled and so much more. How could we hold back from preparing the House of God to be magnificent? Let us not withhold any good thing from God. Let us build for Him.

As we build let us build to reach - the house of God is a house of prayer for all nations not just for us. We are called as a church to not just build, but build to reach. We will build a magnificent place of encounter and, at the same time, build resources to reach out beyond us to plant churches, reach the young and help those in need.

Our vision for *Build to Reach* has not changed. As you give you are giving to build physical and financial resources to reach people locally, nationally and internationally. Let us continue in this work until completion. Nothing is more important than reaching others for Jesus. The Lord bless you as you give generously, sacrificially and with faith in Jesus.

**RICHARD & CATHIE GREEN**  
SENIOR MINISTERS



## About the foundation

"EVERY MEMBER GIVING GENEROUSLY TO BUILD THE HOUSE OF GOD  
IN THE MIDST OF COMMUNITY, AND THE FINANCIAL RESOURCES TO  
REACH AND BUILD PEOPLE" - BUILD TO REACH VISION STATEMENT



**BUILDING FUND**  
A presence within our community



**SCRIPTURE IN SCHOOLS**  
SCOPE  
Taking Jesus into our local schools

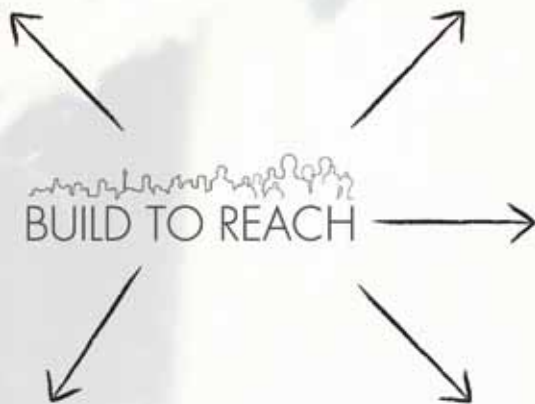

**CHURCH PLANTING**  
Building to reach our beyond



**COMMUNITY CARE ARM**  
REACH COMMUNITY INITIATIVES  
Meeting the practical needs of those in our community



**GLOBAL PARTNERSHIPS**  
Meeting the needs of the poor overseas

## Reach beyond

"BUT YOU WILL RECEIVE POWER WHEN THE HOLY SPIRIT COMES ON YOU; AND YOU WILL BE MY WITNESSES IN JERUSALEM, AND IN ALL JUDEA AND SAMARIA, AND TO THE ENDS OF THE EARTH."  
- ACTS 1:8 (NIV)



**The purpose of the Build to Reach Foundation is to build a resource base to enable us to reach and build beyond.**

It means building a home in the midst of people and a ministry that reaches into the homes of people.

The majority of the activities that are funded by the Build to Reach Foundation enable members of the church to give and receive a tax deduction. There are other activities that are not considered tax deductible, such as any church planting, evangelistic work, and even some preventative life skills training for members of the broader community.

We are called to Build to Reach Beyond - where we can, and when it is right to do so, we will offer tax deductibility. But it is not the tax break to a giver that ought to determine whether or not we give. It is the Word of God and the Lord's call for us to Build to Reach Beyond.

This booklet outlines the areas of our ministry that are 'Reaching Beyond'. These are areas that are beyond our own church - they are about Reaching Beyond locally, nationally and globally. Some are humanitarian, others evangelistic - but all are important.

"For what counts is faith expressing itself through love" (Gal 5:6). We are a church that believes that because God first loved us, we can now love, and although God takes the initiative in His saving grace, we still have free will.

So God moves in our moving, for "faith without works is dead" (James 2:14). As you look at the list of how we Reach Beyond, and the places where we Reach Beyond, let the Holy Spirit stir your faith to partner with us as we "complete the good work that Christ began in us" (Phil 1:6).



# The seed in good soil

STANDS FOR THOSE WITH A NOBLE AND GOOD HEART, WHO HEAR THE WORD, RETAIN IT, AND BY PERSEVERING PRODUCE A CROP.  
- LUKE 8:15 (NIV)



\* Items marked with (T) are tax deductible

#### SCOPE - Scripture in Schools

- Primary & Secondary (T)
- Oxygen - Youth meeting at high school

#### RCI - Local Community Aid - Adult and Family

- Programs and courses (only some are T)
- Foodbank - emergency food parcels (T)
- Christmas Day Lunch
- Single Mums' Pampering Day
- Counselling (some are T)
- CAP - Debt Counselling (T)
- Chaplaincy
- Bushfire Relief (T)
- Crisis Relief e.g. drought and flood relief

#### Youth

- Big Breakfast - at schools (T)
- Impact Youth - shopping centre youth intervention
- Shift - mentoring and car mechanic program (T)
- Educational Building Fund
- New church building and training centre (The Build to Reach Centre) (T)
- Fit-out of new church facilities - certain costs are not tax deductible

#### Church Planting & Support

- C3 Bathurst - Jeff and Rowena Lloyd
- C3 Invercargill, New Zealand - David and Shiree Ross
- C3 Shellharbour - Jason & Tara Kent
- C3 Miranda - satellite
- NSW Metro - Regional Direction
- Jagelman Institute - Dr Ian Jagelman Bible teaching and church consultancy institute
- International church planters support - Bulgaria, Czech Republic, Lebanon, Indonesia

#### Global Aid

- Hope Kids Community Development Program (T)
- PNG Community Aid Projects (T)
- Indonesia - Community Support Homes (widows & orphans) (T)
- Seth Homes China - Joshua and Alex Jagelman. Children with disabilities, abandoned babies, HIV AIDS prevention and treatment and rehabilitation of children at risk. (T)



# The house to be built

FOR THE LORD MUST BE EXCEEDINGLY MAGNIFICENT, OF FAME AND GLORY THROUGHOUT ALL LANDS; I WILL THEREFORE MAKE PREPARATION FOR IT. - 1 CHRONICLES 22:5 (ESV)

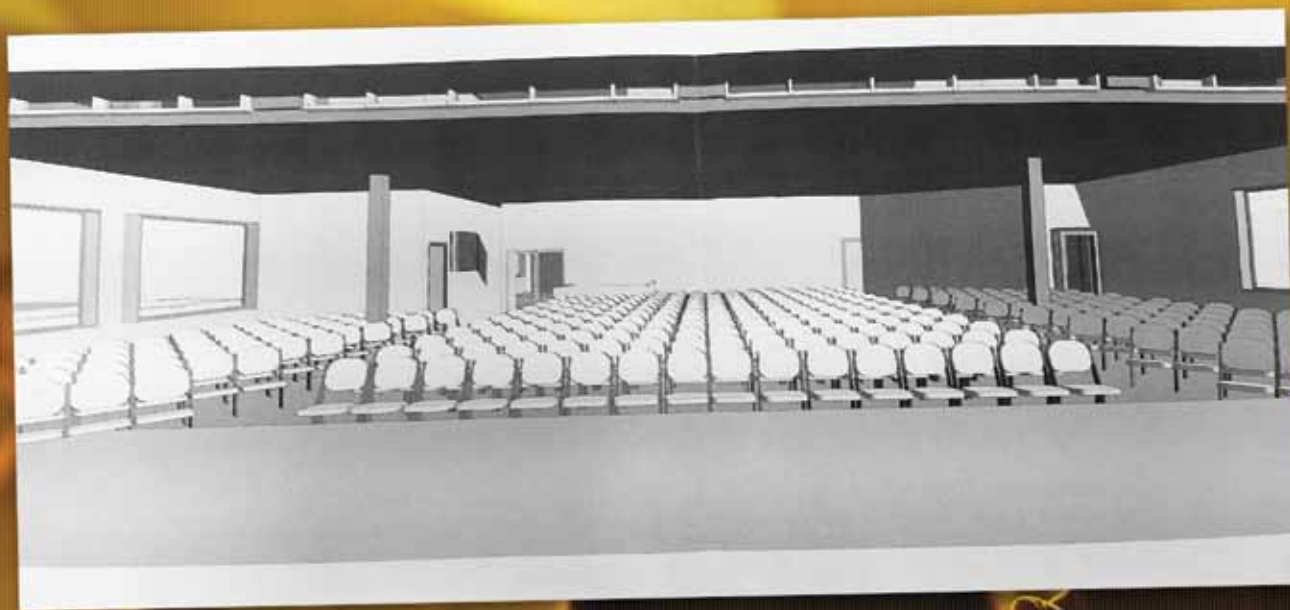

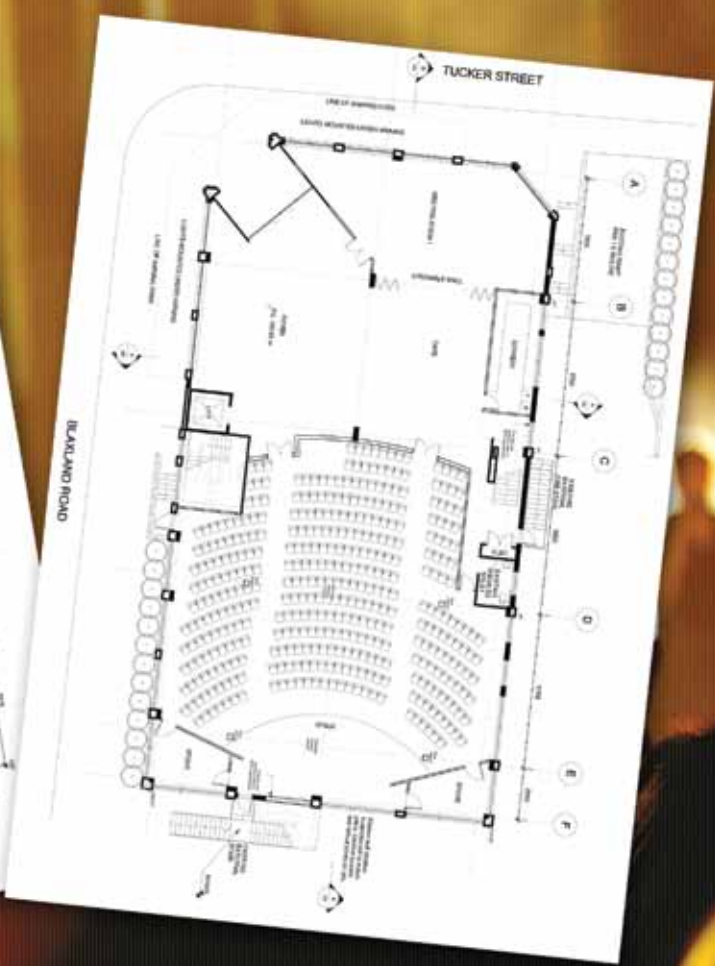

# How to get involved



### 1. Prayerfully consider the amount of giving that is appropriate for you.

This should be your first step in becoming involved in establishing the Build to Reach Foundation. Pray for both faith and wisdom in making your decision.

### 2. Make your commitment to the Build to Reach Foundation.

In June, you will have an opportunity to make your commitment during our services by completing a commitment card.

Alternatively, if you are unable to attend church, you can obtain a commitment card anytime from the Church Office or submit a commitment card online at [www.c3churchryde.com.au](http://www.c3churchryde.com.au).

### 3. Consider how you will fulfil your commitment.

You will have several options available to you:

Make a regular weekly or monthly contribution. Regular giving can be easier to manage, is rewarding and quickly builds up over time, as you can see below:

\$20 week	= \$86 month	= \$1,040 year
\$80 week	= \$346 month	= \$4,160 year
\$300 week	= \$1,300 month	= \$15,000 year
\$1,000 week	= \$4,332 month	= \$52,000 year

### 4. Regularly pray into your commitment

Place your statement of commitment in a place where you and your family can see it and pray regularly for it e.g. the fridge. The actual amount will not be on the front of your Commitment Focus Card.

### Creative Ways To Give

1. As a family, give up one of your takeaway meals a week for a meal at home. Missing one meal a week at an average of \$20 per family is \$1,040 per year.

2. Give up a habit. Easier said than done, but not impossible. A cappuccino per day for a year costs \$1,095.

3. Commit your income tax refund to the Lord.

4. Give a gift of assets. You can give real estate, stocks, bonds, gold, cars, boats, etc.

5. Adjust your holiday. Try having a holiday at home and taking day trips and picnics. Or take a three day holiday instead of a week. This can save \$1,000 - \$2,000.

6. Wait for a movie to come out on video instead of seeing it at the theatre. A trip to the movies for two people costs approximately \$40 with tickets, popcorn and a drink. If you cut out one movie a month that is \$480 over the year.

7. Put off a major purchase and redirect the money into Build to Reach.

8. If you have a business, consider making a gift which is tax deductible to the business.

9. A dollar increase per week. This is a great idea for those who have never given or do not see a way to increase current giving. Start by giving one dollar the first week, then two, then three, etc., praying all along that the Lord would show you a way to add that next dollar and increase each week. If you keep this up for a year you would give \$1,345.

10. Trust Distributions. Input tax credits that apply to distributions from trust funds - these are able to be refunded to the church from the tax office.

## Account information

NOW HE WHO SUPPLIES SEED TO THE SOWER AND BREAD FOR FOOD  
WILL ALSO SUPPLY AND INCREASE YOUR STORE OF SEED AND WILL  
ENLARGE THE HARVEST OF YOUR RIGHTEOUSNESS.

- 2 CORINTHIANS 9:10 (NIV)





**There are two different accounts you can give to.**

1. If you *require a tax receipt* for tax deductibility purposes (all donations over \$2 are tax deductible), you should give to the Build to Reach Foundation.

For direct deposits our account details are :

Name of account: Build to Reach Foundation

BSB: 062 281

Account Number: 1026 6521

Cheques should be made payable to the Build to Reach Foundation.

Cash donations should be placed in our "offering" envelopes and the "Build to Reach Foundation" box ticked.

2. If you *do not require a tax receipt* (ie you do not wish to claim your donation as a tax deduction), you can give to the Christian City Church Ryde Special Account.

Money given to this account will be used for expenditure beyond the purposes approved by the Australian Tax Office for the tax deductible Build to Reach Foundation Fund. Some aspects of the building fitout, activities such as church planting, local and overseas missions that are evangelistic, are not approved by the Australian Tax Office for tax deductibility.

For direct deposits our account details are:

Name of account: Christian City Church Ryde Special Account

BSB: 062 320

Account Number: 1019 8068

Cheques should be made payable to Christian City Church Ryde.

Cash donations should be placed in our "offering" envelopes and the "Building Fund" box ticked.



  
BUILD TO REACH

## **C3 CHURCH RYDE**

PO BOX 919 RYDE NSW 1680  
P +61 2 9086 6900 F +61 2 9086 6950  
E [buildtoreach@c3churchryde.com.au](mailto:buildtoreach@c3churchryde.com.au)  
[www.c3churchryde.com.au](http://www.c3churchryde.com.au)